

1 D1 Space - First Floor Plan  
Scale: 1:100

T 1	12/10/2021	display case edited, loose furniture revised
P 4	26/08/2021	ISSUE FOR COSTING
P 3	23/07/2021	Revisions to L1 Internal layout, additional glazing to meeting rooms
P 2	22/06/2021	D1 space layout revised
P 1	04/06/2021	DRAFT ISSUE
REV.	DATE	COMMENT

1:100  
0 1 2 3m

NOTES  
Do not scale from this drawing. All dimensions to be confirmed on site. Architect to be informed of any discrepancies before any action is taken. This drawing is copyright © Manalo & White Ltd and should not be copied or reproduced without Manalo & White Ltd consent.

Manalo & White

UNIT 301, METROPOLITAN WHARF BUILDING,  
70 WAPPING WALL, LONDON E1W 3SS  
T 020 7265 4945 E contact@manaloandwhite.co.uk

PROJECT  
Unite: Middlesex St  
DRAWING  
D1 - Plan 1F  
SCALE  
1:100 @A3  
STATUS  
Information

PROJECT No.	REVISION
1107	T 1
DRAWING No.	
04 0212	

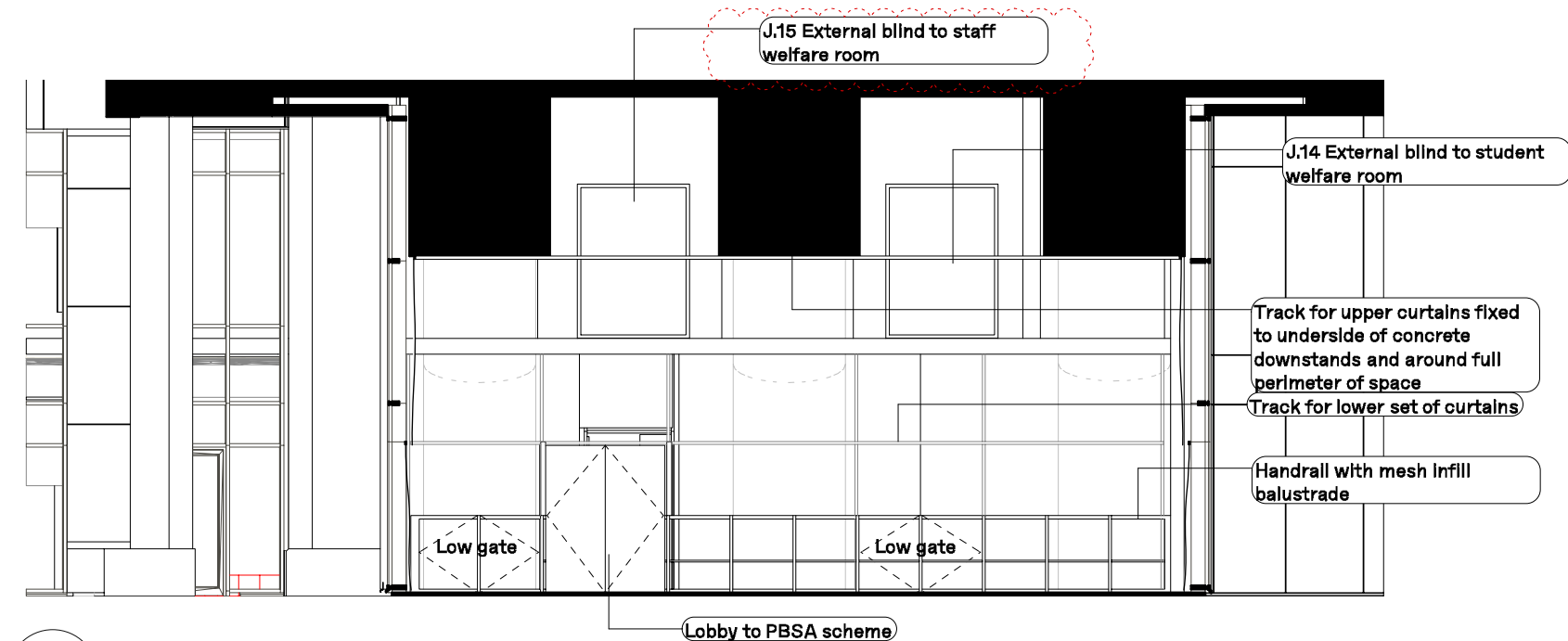

4

**Section C-C**  
Scale: 1:100

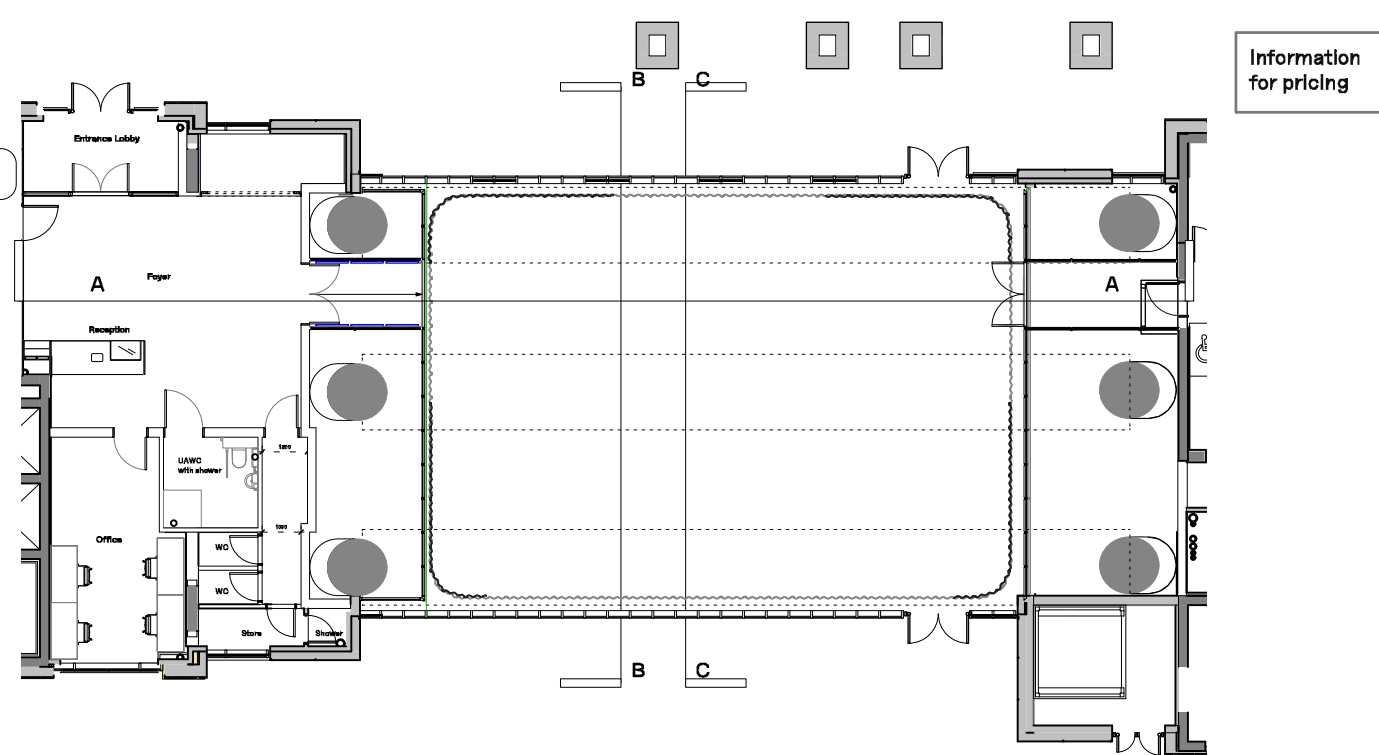

1

**D1 key plan**  
Scale: 1:200



3

**Section B-B**  
Scale: 1:100

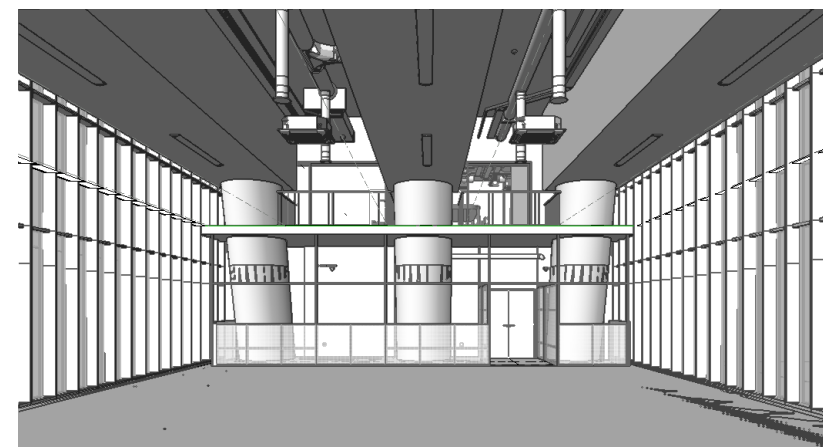

5

**View towards D1 meeting rooms**

note - view shown without curtains

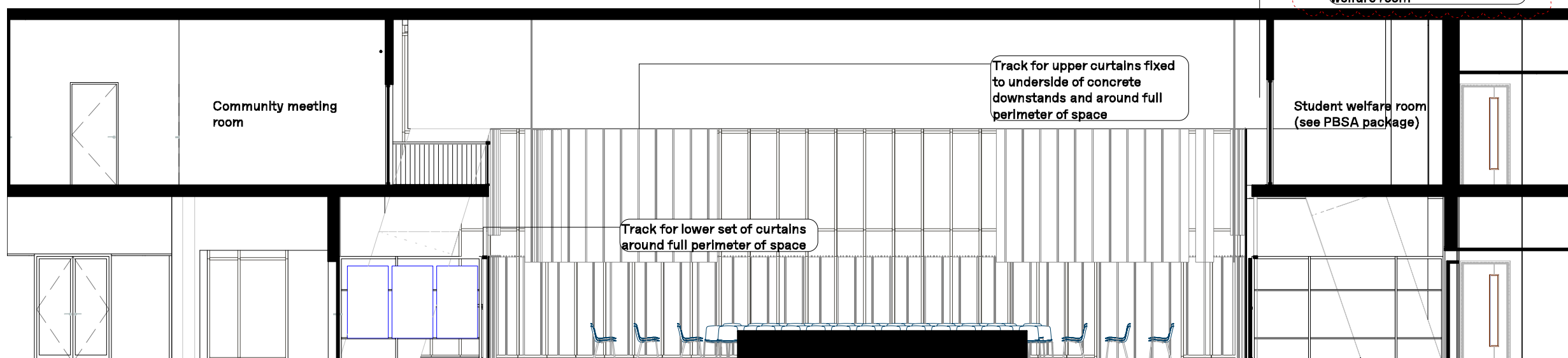

2

**Section A-A**  
Scale: 1:100

T 1	12/10/2021	Joinery codes added for external blinds
P 2	08/10/2021	Handrall update to performance space
P 1	23/07/2021	preliminary Issue
REV.	DATE	COMMENT

1:100  
0 1 2 3m

NOTES  
Do not scale from this drawing. All dimensions to be confirmed on site. Architect to be informed of any discrepancies before any action is taken. This drawing is copyright © Manalo & White Ltd and should not be copied or reproduced without Manalo & White Ltd consent.

**Manalo & White**

UNIT 301, METROPOLITAN WHARF BUILDING,  
70 WAPPING WALL, LONDON E1W 3SS  
T 020 7265 4945 E contact@manaloandwhite.co.uk

PROJECT  
**Unite: Middlesex St**

DRAWING  
**Section D1**

SCALE  
**1:100**

STATUS  
**Information**

PROJECT No.

**1107**

DRAWING No.

**04 0500**

REVISION

**T 1**

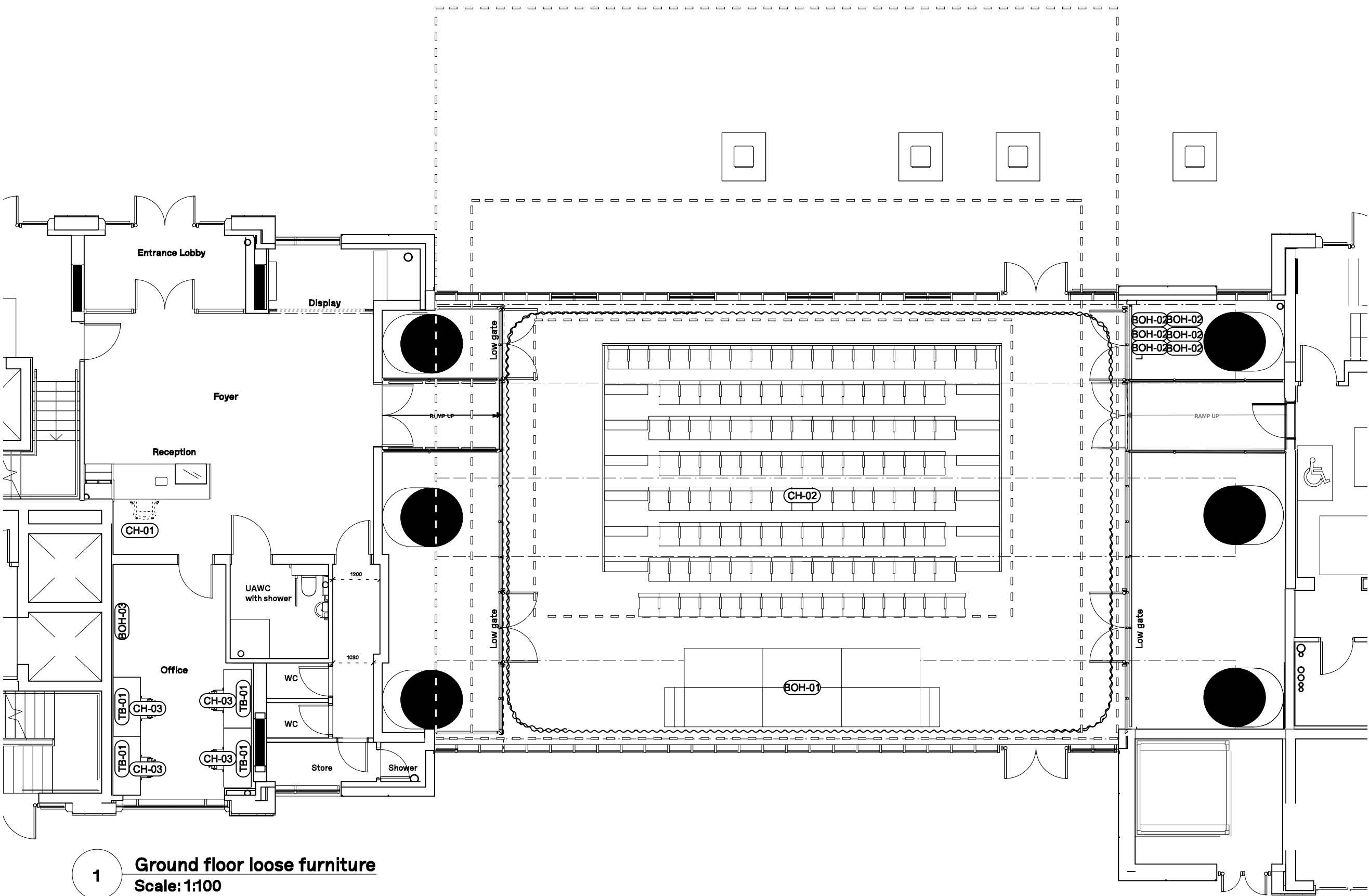

T 1	12/10/2021	Stage 4 Issue for costing
REV.	DATE	COMMENT

1:100  
0 1 2 3m

NOTES  
Do not scale from this drawing. All dimensions to be confirmed on site. Architect to be informed of any discrepancies before any action is taken. This drawing is copyright © Manalo & White Ltd and should not be copied or reproduced without Manalo & White Ltd consent.

## Manalo & White

UNIT 301, METROPOLITAN WHARF BUILDING,  
70 WAPPING WALL, LONDON E1W 3SS  
T 020 7265 4945 Econtact@manaloandwhite.co.uk

PROJECT  
**Unite: Middlesex St**  
DRAWING  
**D1\_GF FFE Layout**  
SCALE  
**1:100 @A3**  
STATUS  
**Information**

PROJECT No.	REVISION
<b>1107</b>	<b>T 1</b>
DRAWING No.	
<b>04 8001</b>	

1

**Ground floor loose furniture**  
**Scale: 1:100**

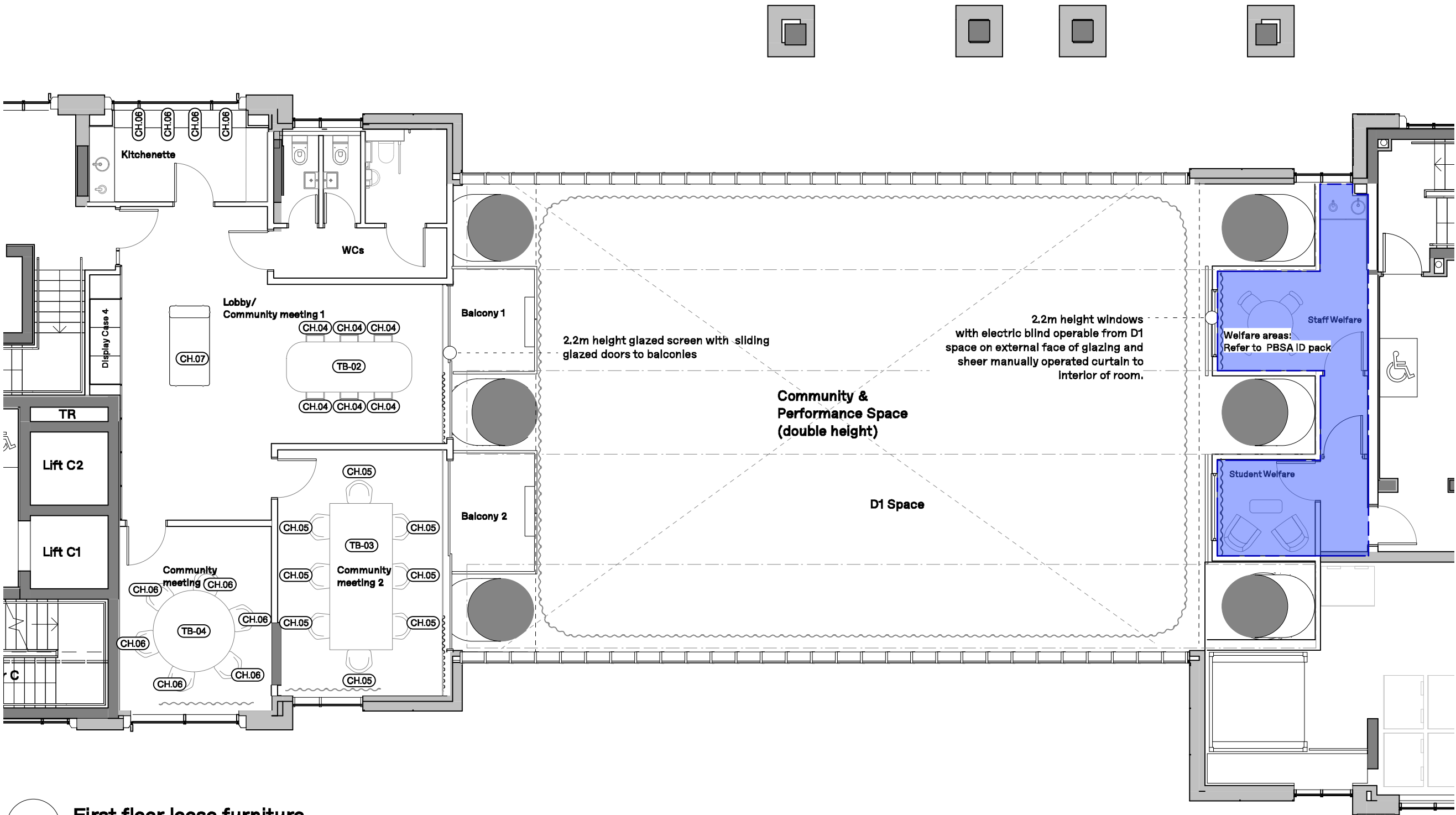

T 1 12/10/2021 Stage 4 Issue for costing  
REV. DATE COMMENT

1:100  
0 1 2 3m

NOTES  
Do not scale from this drawing. All dimensions to be confirmed on site. Architect to be informed of any discrepancies before any action is taken. This drawing is copyright © Manalo & White Ltd and should not be copied or reproduced without Manalo & White Ltd consent.

**Manalo & White**

UNIT 301, METROPOLITAN WHARF BUILDING,  
70 WAPPING WALL, LONDON E1W 3SS  
T 020 7265 4945 Econtact@manaloandwhite.co.uk

PROJECT  
**Unite: Middlesex St**  
DRAWING  
**D1\_1F FFE Layout**  
SCALE  
**1:100 @A3**  
STATUS  
**Information**

PROJECT No.  
**1107**  
DRAWING No.  
**04 8100**  
REVISION  
**T 1**

1 **First floor loose furniture**  
Scale: 1:100

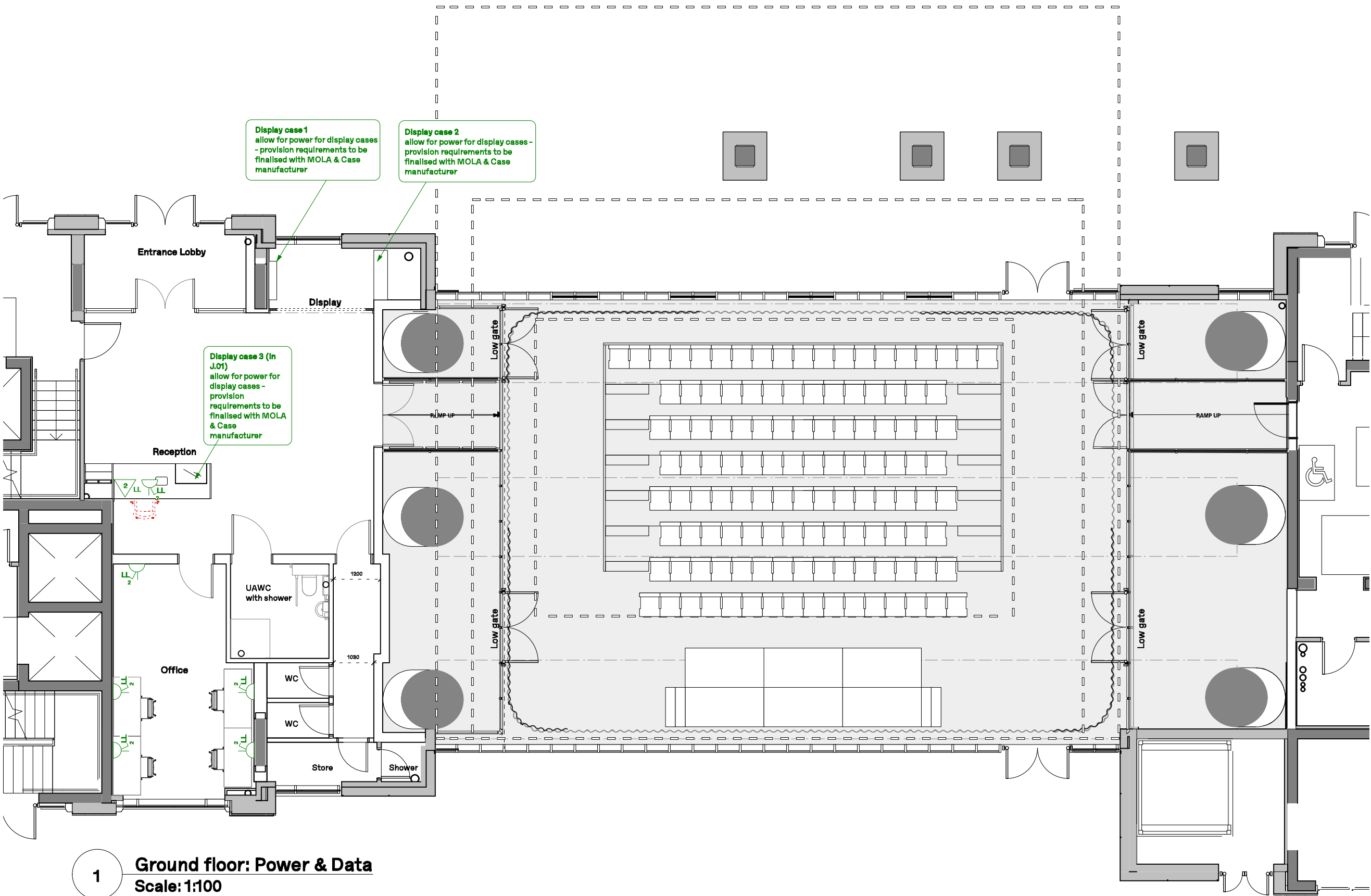

Legend User required power and data	
	Low Level DSO
	Low Level DSO with USB
	High Level DSO
	Low Level FSO
	DSO with USB Integrated into bespoke joinery at table height
	Counter height DSO Integrated into bespoke joinery at +1100 AFFL
	Low Level Twin Data point
	High Level Twin Data point
	Floor Box: 2 DSO, Data point, HDMI (TBC)

T	1	12/10/2021	Stage 4 Issue for costing
REV.		DATE	COMMENT

1:100  
0 1 2 3m

NOTES  
Do not scale from this drawing. All dimensions to be confirmed on site. Architect to be informed of any discrepancies before any action is taken. This drawing is copyright © Manalo & White Ltd and should not be copied or reproduced without Manalo & White Ltd consent.







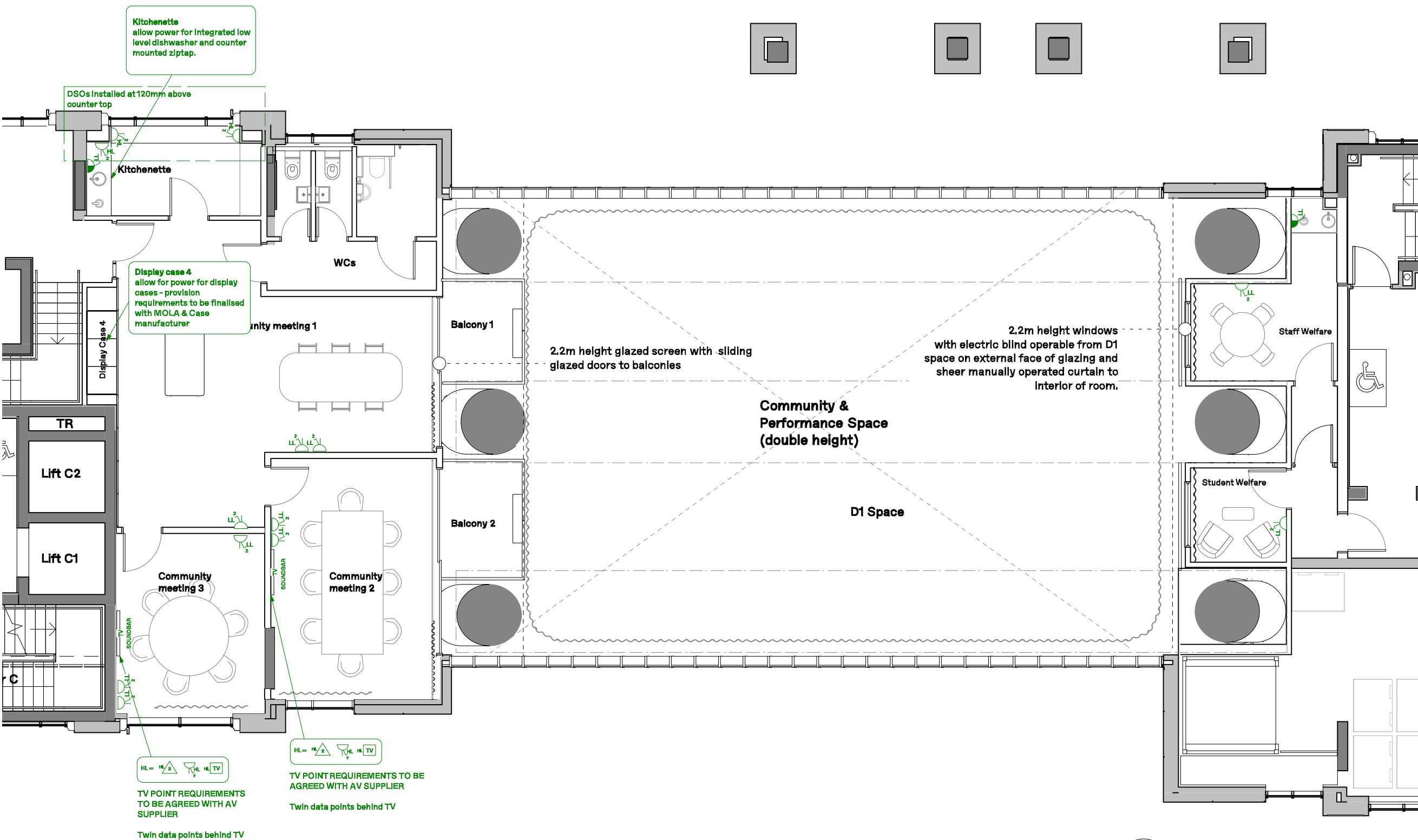

**Manalo & White**

UNIT 301, METROPOLITAN WHARF BUILDING,  
70 WAPPING WALL, LONDON E1W 3SS  
T 020 7265 4945 Econtact@manaloandwhite.co.uk

PROJECT  
**Unite: Middlesex St**  
DRAWING  
**D1 - GF User required power & data**  
**1:100 @A3**  
STATUS  
**Information**

PROJECT No.	REVISION
<b>1107</b>	<b>T 1</b>
DRAWING No.	
<b>04 6000</b>	



Legend	
User required power and data	
	Low Level DSO
	Low Level DSO with USB
	High Level DSO
	Low Level FSO
	DSO with USB Integrated into bespoke joinery at table height
	Counter height DSO Integrated into bespoke joinery at +1100 AFFL
	Low Level Twin Data point
	High Level Twin Data point
	Floor Box: 2 DSO, Data point, HDMI (TBC)

T 1	12/10/2021	Stage 4 Issue for costing
REV.	DATE	COMMENT

1:100

0 1 2 3m

**NOTES**  
Do not scale from this drawing. All dimensions to be confirmed on site. Architect to be informed of any discrepancies before any action is taken. This drawing is copyright © Manalo & White Ltd and should not be copied or reproduced without Manalo & White Ltd consent.

## Manalo & White

UNIT 301, METROPOLITAN WHARF BUILDING,  
70 WAPPING WALL, LONDON E1W 3SS  
T 020 7265 4945 E [contact@manaloandwhite.co.uk](mailto:contact@manaloandwhite.co.uk)

PROJECT  
**Unite: Middlesex St**

DRAWING  
**D1 - 1F User required power & data**

**1:100 @A3**

STATUS  
**Information**

PROJECT No.	REVISION
<b>1107</b>	<b>T 1</b>

DRAWING No.  
**04 6100**



RCP key

Description	
Spotlight	
Directional Spotlight	
Pendant	
Linear	
Track	
Wall Light	
Floor/ Table Lamp	
External lighting for IN.03 Signpainted window artwork	
JD. 06 Curtain and track	

Ceiling finishes key

Description	
Exposed Concrete ceiling & ductwork	
Suspended Plasterboard with paint finish Ref: Little Greene Scree 227	
Suspended Plasterboard with paint finish Ref: Little Greene Book Room Green	
Suspended Plasterboard with paint finish Ref: Little Greene Nether Red	
Suspended Plasterboard with paint finish Ref: Little Greene China Clay 1	

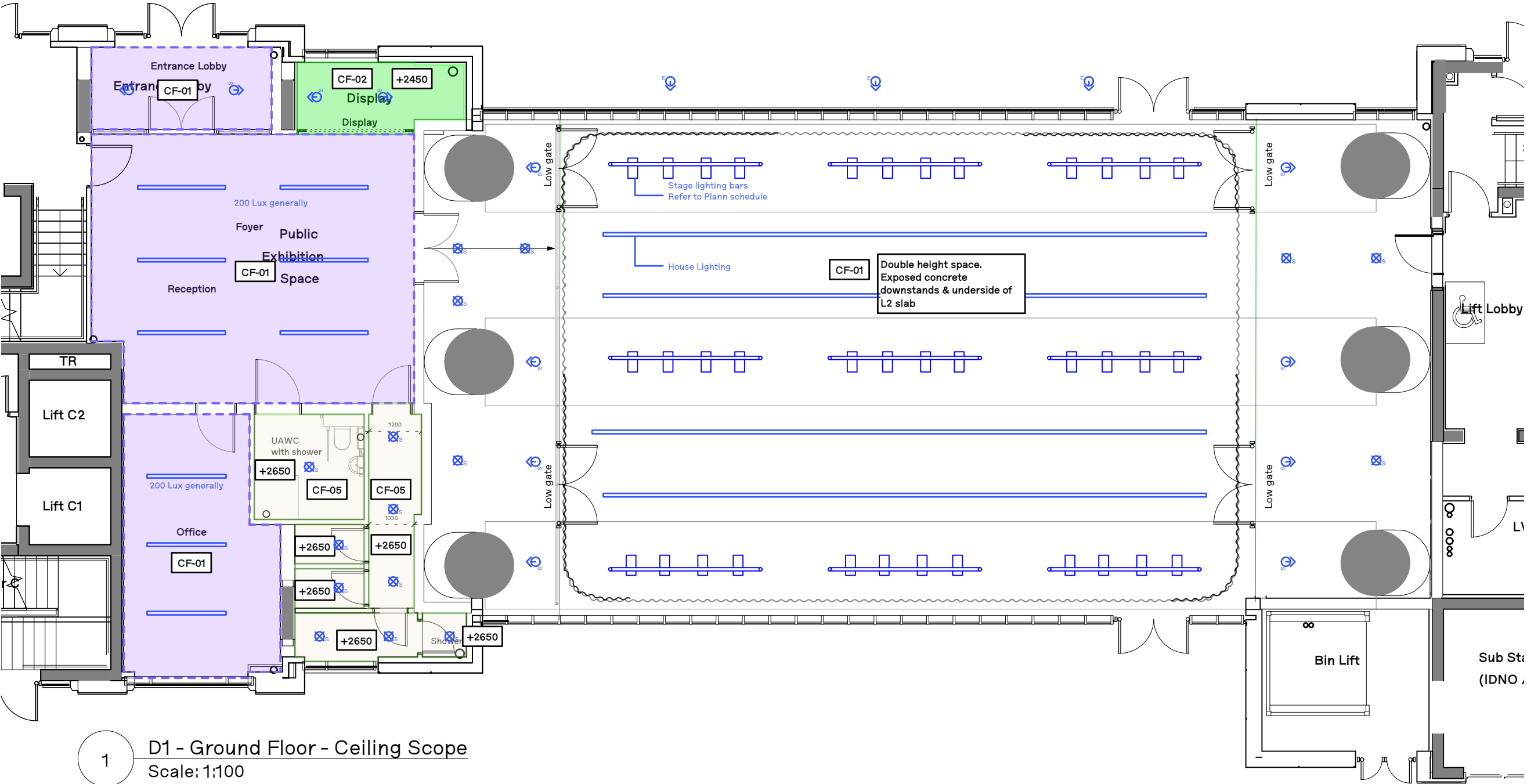
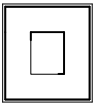
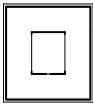
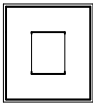
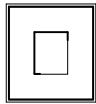

T 1	12/10/2021	Finishes references added
P 2	26/08/2021	ISSUE FOR COSTING
P 1	22/06/2021	Preliminary Issue
REV.	DATE	COMMENT

1:100  
1:100  
0 1 2 3m  
NOTES  
Do not scale from this drawing. All dimensions to be confirmed on site. Architect to be informed of any discrepancies before any action is taken. This drawing is copyright © Manalo & White Ltd and should not be copied or reproduced without Manalo & White Ltd consent.

Manalo & White

UNIT 301, METROPOLITAN WHARF BUILDING,  
70 WAPPING WALL, LONDON E1W 3SS  
T 020 7265 4945 E contact@manaloandwhite.co.uk

PROJECT  
Unite: Middlesex St

DRAWING  
D1 - Ceiling Scope GF





SCALE  
1:100 @A3





STATUS  
Information

PROJECT No.	REVISION
1107	T 1

DRAWING No.  
04 4160



RCP key	
Description	
 S	Spotlight
 S	Directional Spotlight
 P	Pendant
	Linear
	Track
 W	Wall Light
 L	Floor/ Table Lamp
 E	External lighting for IN.03 Signpainted window artwork
JD. 06 Curtain and track	

Ceiling finishes key	
Description	
 CF-01	Exposed Concrete ceiling & ductwork
 CF-02	Suspended Plasterboard with paint finish Ref: Little Greene Scree 227
 CF-03	Suspended Plasterboard with paint finish Ref: Little Greene Book Room Green
 CF-04	Suspended Plasterboard with paint finish Ref: Little Greene Nether Red
 CF-05	Suspended Plasterboard with paint finish Ref: Little Greene China Clay 1

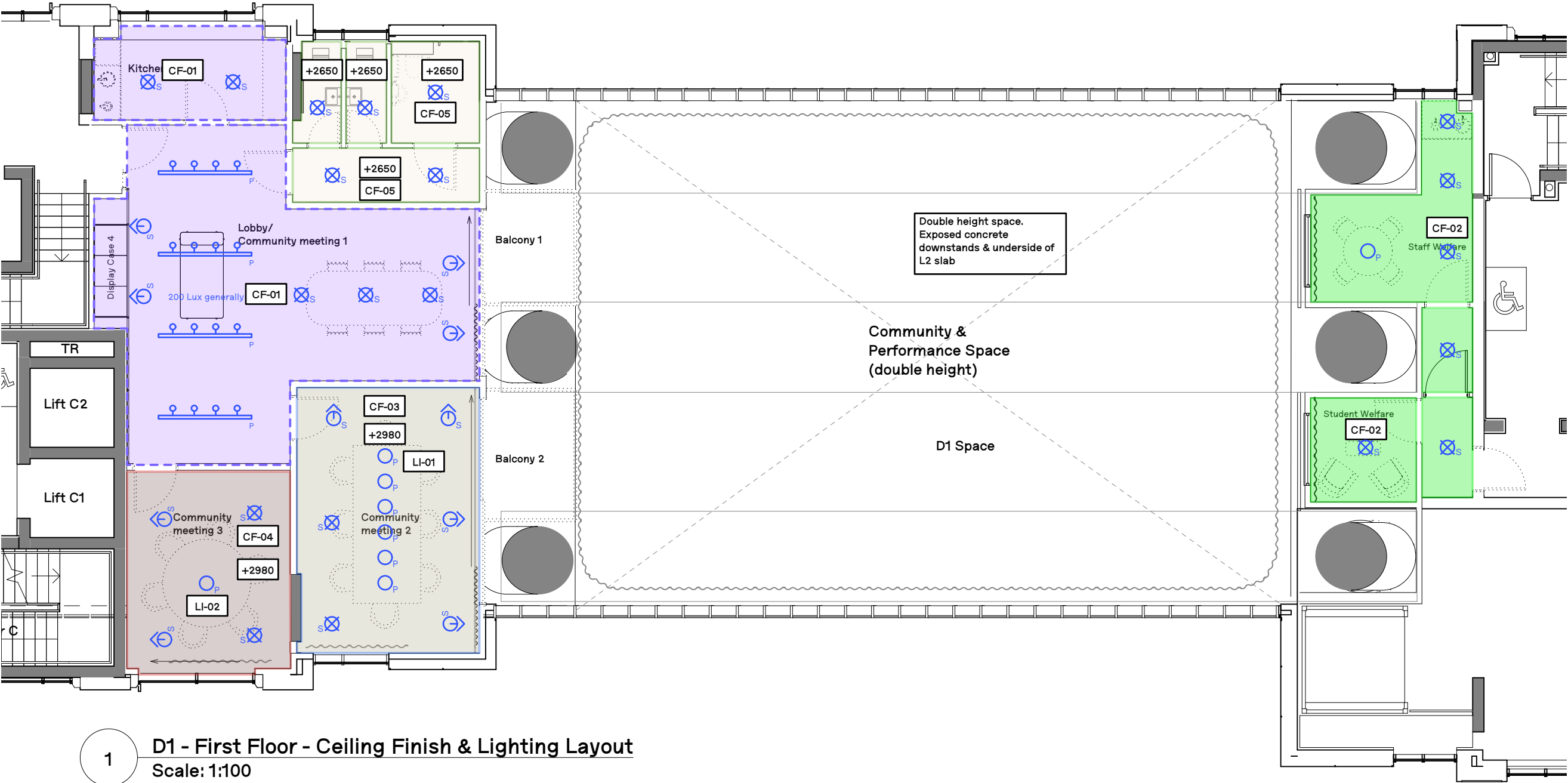

T 1 12/10/2021 Finishes references added

P 1 26/08/2021 ISSUE FOR COSTING  
REV. DATE COMMENT

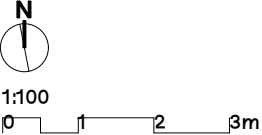

NOTES  
Do not scale from this drawing. All dimensions to be confirmed on site. Architect to be informed of any discrepancies before any action is taken. This drawing is copyright © Manalo & White Ltd and should not be copied or reproduced without Manalo & White Ltd consent.

**Manalo & White**

UNIT 301, METROPOLITAN WHARF BUILDING,  
70 WAPPING WALL, LONDON E1W 3SS  
T 020 7265 4945 E contact@manaloandwhite.co.uk

PROJECT  
**Unite: Middlesex St**

DRAWING  
**D1 - Ceiling Scope 1F**

SCALE  
**1:100**

STATUS  
**Information**

PROJECT No. REVISION

**1107 T 1**

DRAWING No.

**04 4161**

Wall finishes key	
Description	
<div><div></div></div> Exposed Concrete Finish	
WF-00	
<div><div></div></div> Wall Paint Supplier: Little Greene (or equal and approved Ref: Scree	
WF-01	
<div><div></div></div> Wall Paint Supplier: Little Greene (or equal and approved Ref: Nether Red 315	
WF-02	
<div><div></div></div> Wall Paint Supplier: Little Greene (or equal and approved Ref: Blush 267	
WF-03	
<div><div></div></div> Wall Paint Supplier: Little Greene (or equal and approved Ref: Light peachblossom 3	
WF-04	
<div><div></div></div> Wall Paint Supplier: Little Greene (or equal and approved Ref: Masquerade Mid 333	
WF-05	

Description	
<div><div></div></div> Wall Paint Supplier: Little Greene (or equal and approved Ref: Masquerade 334	
WF-06	
<div><div></div></div> Wall Paint Supplier: Little Greene (or equal and approved Ref: Roman plaster 31	
WF-07	
<div><div></div></div> Wall Paint Supplier: Little Greene (or equal and approved Ref: Regency Fawn	
WF-08	
<div><div></div></div> Wall Paint Supplier: Little Greene (or equal and approved Ref: Light Bronze Green 123	
WF-09	
<div><div></div></div> Wall Paint Supplier: Little Greene (or equal and approved Ref: Book Room Green 322	
WF-10	

Description	
<div><div></div></div> Bespoke digitally printed wall covering ref: Digimura 2.1	
WF-11	
<div><div></div></div> Wall Tiles Ref: Domus Biscuit, white plain	
WF-12	
<div><div></div></div> Half height wall tile with wall paint Tile ref: Domus biscuit green plain Paint ref: Little Greene Roman Plaster	
WF-13	
<div><div></div></div> Handrail and Mesh balustrade to have white paint finish	
WF-14	

Information for pricing

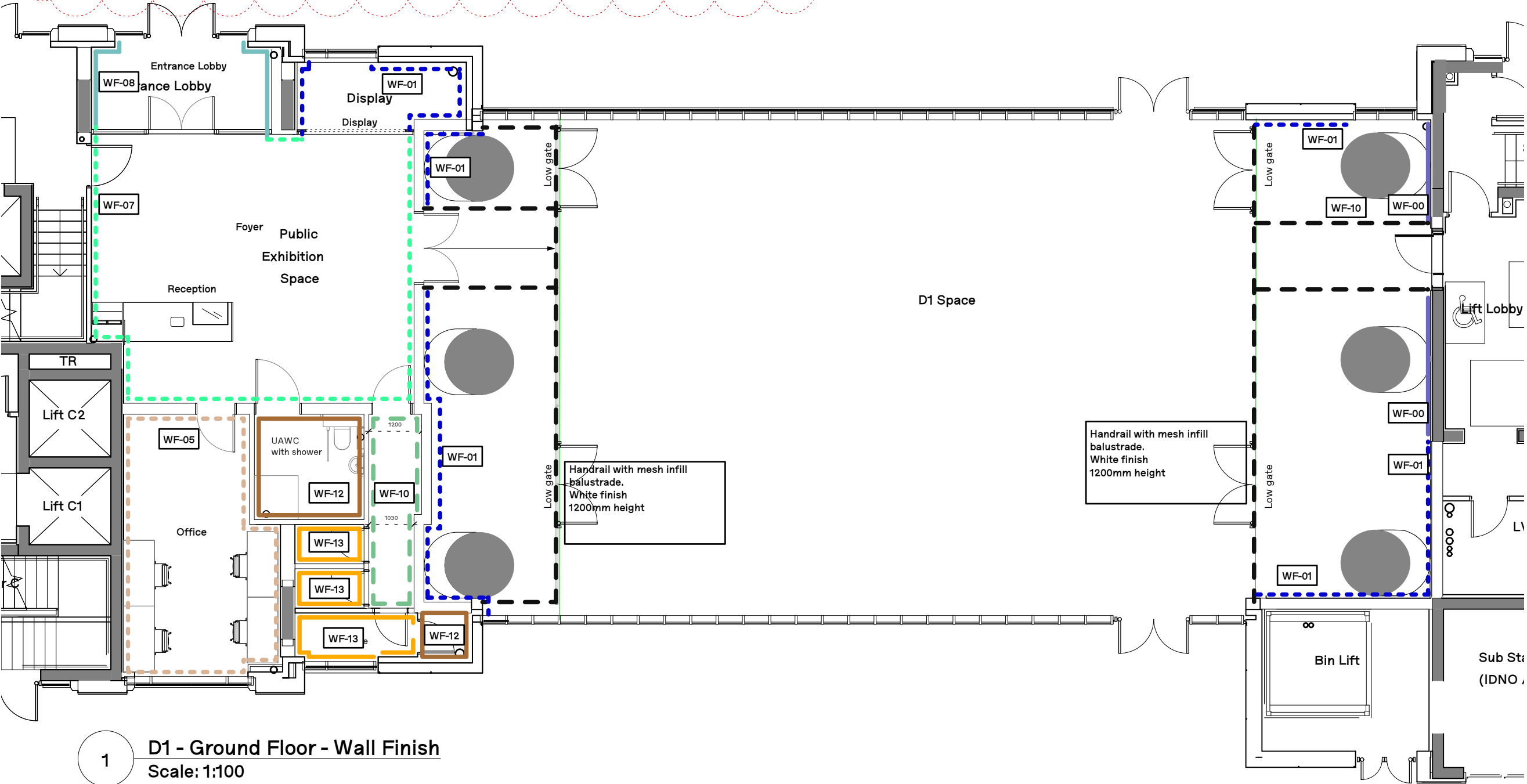

T 1	12/10/2021	Finishes references added
P 2	26/08/2021	ISSUE FOR COSTING
P 1	22/06/2021	Preliminary Issue
REV.	DATE	COMMENT

1:100  
1:100  
0 1 2 3m  
NOTES  
Do not scale from this drawing. All dimensions to be confirmed on site. Architect to be informed of any discrepancies before any action is taken. This drawing is copyright © Manalo & White Ltd and should not be copied or reproduced without Manalo & White Ltd consent.

**Manalo & White**  
UNIT 301, METROPOLITAN WHARF BUILDING,  
70 WAPPING WALL, LONDON E1W 3SS  
T 020 7265 4945 E contact@manaloandwhite.co.uk

PROJECT  
**Unite: Middlesex St**  
DRAWING  
**D1 - Wall Finish GF**  
SCALE  
**1:100 @A3**  
STATUS  
**Information**

PROJECT No.	REVISION
<b>1107</b>	<b>T 1</b>
DRAWING No.	
<b>04 4150</b>	

Wall finishes key

Description
<div><div></div>Exposed Concrete Finish</div> <div>WF-00</div>
<div><div></div>Wall Paint Supplier: Little Greene (or equal and approved Ref: Scree</div> <div>WF-01</div>
<div><div></div>Wall Paint Supplier: Little Greene (or equal and approved Ref: Nether Red 315</div> <div>WF-02</div>
<div><div></div>Wall Paint Supplier: Little Greene (or equal and approved Ref: Blush 267</div> <div>WF-03</div>
<div><div></div>Wall Paint Supplier: Little Greene (or equal and approved Ref: Light peachblossom 3</div> <div>WF-04</div>
<div><div></div>Wall Paint Supplier: Little Greene (or equal and approved Ref: Masquerade Mid 333</div> <div>WF-05</div>

Description
<div><div></div>Wall Paint Supplier: Little Greene (or equal and approved Ref: Masquerade 334</div> <div>WF-06</div>
<div><div></div>Wall Paint Supplier: Little Greene (or equal and approved Ref: Roman plaster 31</div> <div>WF-07</div>
<div><div></div>Wall Paint Supplier: Little Greene (or equal and approved Ref: Regency Fawn</div> <div>WF-08</div>
<div><div></div>Wall Paint Supplier: Little Greene (or equal and approved Ref: Light Bronze Green 123</div> <div>WF-09</div>
<div><div></div>Wall Paint Supplier: Little Greene (or equal and approved Ref: Book Room Green 322</div> <div>WF-10</div>

Description
<div><div></div>Bespoke digitally printed wall covering ref: Digimura 2.1</div> <div>WF-11</div>
<div><div></div>Wall Tiles Ref: Domus Biscuit, white plain</div> <div>WF-12</div>
<div><div></div>Half height wall tile with wall paint Tile ref: Domus biscuit green plain Paint ref: Little Greene Roman Plaster</div> <div>WF-13</div>
<div><div></div>Handrail and Mesh balustrade to have white paint finish</div> <div>WF-14</div>

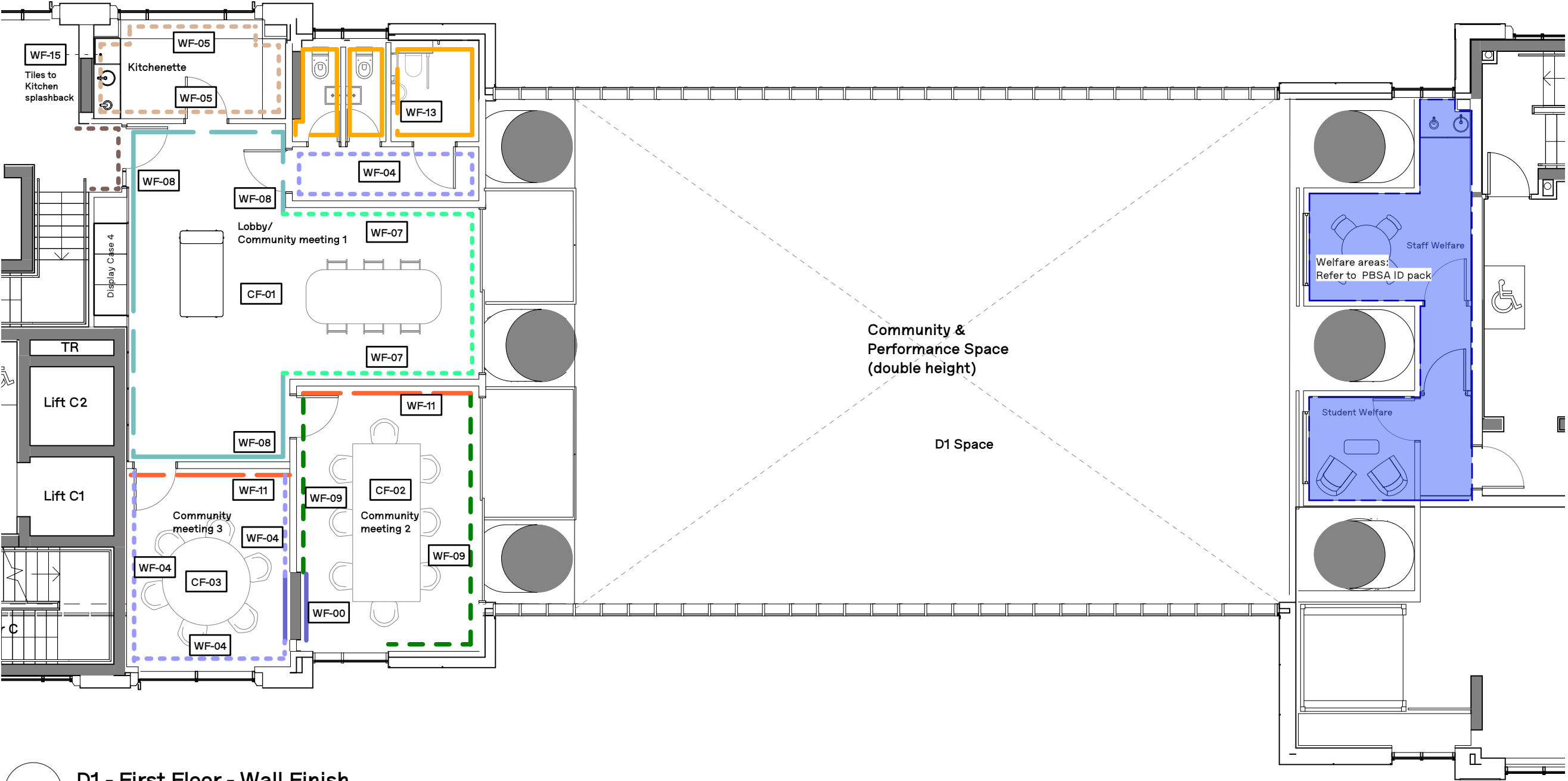

T 1 12/10/2021 Finishes references added

P 1 26/08/2021 ISSUE FOR COSTING  
REV. DATE COMMENT



NOTES  
Do not scale from this drawing. All dimensions to be confirmed on site. Architect to be informed of any discrepancies before any action is taken. This drawing is copyright © Manalo & White Ltd and should not be copied or reproduced without Manalo & White Ltd consent.

Manalo & White

UNIT 301, METROPOLITAN WHARF BUILDING,  
70 WAPPING WALL, LONDON E1W 3SS  
T 020 7265 4945 E contact@manaloandwhite.co.uk

PROJECT  
**Unite: Middlesex St**  
DRAWING  
**D1 - Wall Finish 1F**  
SCALE  
**1:100**  
STATUS  
**Information**



PROJECT No.  
**1107**  
DRAWING No.  
**04 4151**

REVISION  
**T 1**

Floor finishes key		
	Description	Thickness
FF-01	<b>Entrance Matting</b> Supplier: Forbo Ref: Nuway Tufitguard with coconut matting inserts	12-17mm
FF-02	<b>Microcement</b> Refer to 1107 INCUBATOR information, drawing number: 1107 04 0306	6-9mm
FF-03	<b>Luxury Vinyl Planks</b> Supplier: Forbo Ref: Allura Wood steamed Oak	3.2mm
FF-04	<b>Luxury Vinyl Planks</b> Supplier: Forbo Ref: Allura Wood Grey collage oak	3.2mm
FF-05	<b>Non slip rubber flooring</b> Supplier: Noraplan Ref: Unita 7111	2mm
FF-06	<b>Natural Sisal Carpet</b> Supplier: Knotistry Ref: No Bother Sisal super bouclé Netherton Carpet	9mm

  

	Description	Thickness
FF-07	<b>Kitchen tile</b> Supplier: Knotistry Ref: Sardinia 400 x 400mm tile	19mm
FF-08	<b>Sprung Floor</b> Supplier: Harlequin uk.harlequinfloors.com Floor system: Harlequin Activity Vinyl finish: Clarity  Vinyl finish to be underside printed to match RAL 8025 with contrasting dashed line graphic to match RAL 9002. (note: printing carried out by manufacturer)	48mm  (46mm floating sprung floor system with 2mm vinyl finish. )
FF-09	<b>Concrete Sealant</b> Allow for concrete sealant to be applied to floor surface on the balconies	

Description		Thickness
 <b>FF-07</b>	<b>Kitchen tile</b> Supplier: Knotistry Ref: Sardinia 400 x 400mm tile	19mm
 <b>FF-08</b>	<b>Sprung Floor</b> Supplier: Harlequin <a href="http://uk.harlequinfloors.com">uk.harlequinfloors.com</a> Floor system: Harlequin Activity Vinyl finish: Clarity  Vinyl finish to be underside printed to match RAL 8025 with contrasting dashed line graphic to match RAL 9002. (note: printing carried out by manufacturer)	48mm  (46mm floating sprung floor system with 2mm vinyl finish. )
 <b>FF-09</b>	<b>Concrete Sealant,</b> Allow for concrete sealant to be applied to floor surface on the balconies	





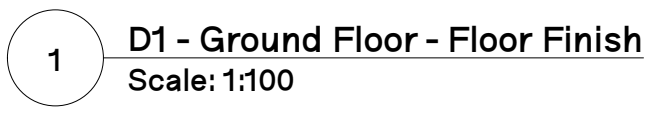

FF-10  
Harlequin Activity Floor



2



PROJECT No.	REVISION
<b>1107</b>	<b>T 1</b>
DRAWING No.	
<b>04 4100</b>	

~~Floor finishes key~~

Description		Thickness
	<b>Entrance Matting</b> Supplier: Forbo Ref: Nuway Tuftiguard with coconut matting inserts	12-17mm
	<b>Microcement</b> Refer to 1107 INCUBATOR Information, drawing number: 1107 04 0306	6-9mm
	<b>Luxury Vinyl Planks</b> Supplier: Forbo Ref: Allura Wood steamed Oak	3.2mm
	<b>Luxury Vinyl Planks</b> Supplier: Forbo Ref: Allura Wood Grey collage oak	3.2mm
	<b>Non slip rubber flooring</b> Supplier: Noraplan Ref: Unita 7111	2mm
	<b>Natural Sisal Carpet</b> Supplier: Knotistry Ref: No Bother Sisal super bouclé Netherton Carpet	9mm

Description		Thickness
	<b>Kitchen tile</b> Supplier: Knotistry Ref: Sardinia 400 x 400mm tile	19mm
	<b>Sprung Floor</b> Supplier: Harlequin uk.harlequinfloors.com Floor system: Harlequin Activity Vinyl finish: Clarity  Vinyl finish to be underside printed to match RAL 8025 with contrasting dashed line graphic to match RAL 9002. (note: printing carried out by manufacturer)	48mm  (46mm floating sprung floor system with 2mm vinyl finish. )
	<b>Concrete Sealant</b> Allow for concrete sealant to be applied to floor surface on the balconies	

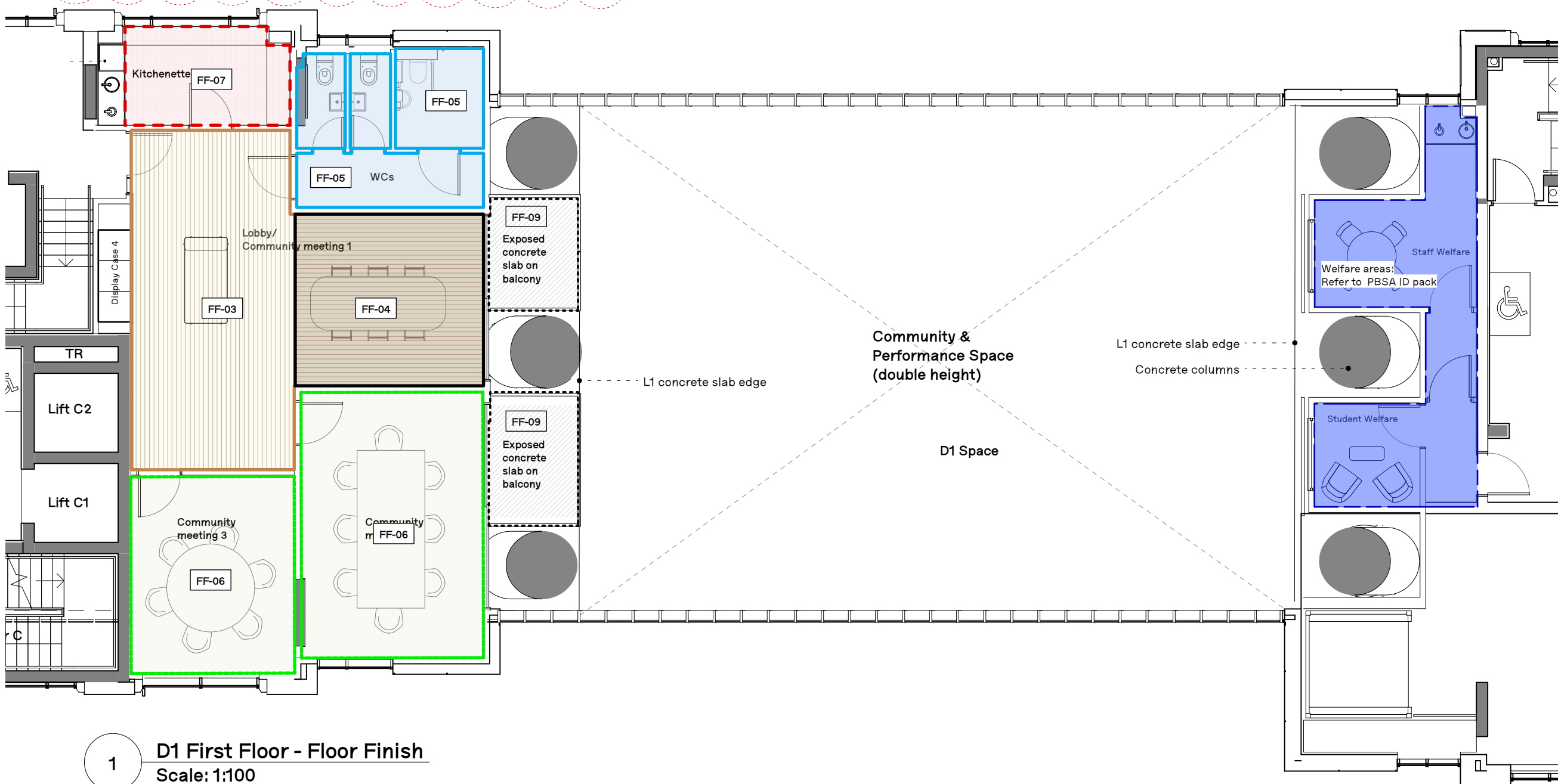

T 1 12/10/2021 Finishes references added

P 1	26/08/2021	ISSUE FOR COSTING
REV.	DATE	COMMENT



1:100

0      1      2      3m

## NOTES

Do not scale from this drawing. All dimensions to be confirmed on site. Architect to be informed of any discrepancies before any action is taken. This drawing is copyright © Manalo & White Ltd and should not be copied or reproduced without Manalo & White Ltd consent.

## Manalo & White

UNIT 301, METROPOLITAN WHARF BUILDING,  
70 WAPPING WALL, LONDON E1W 3SS  
T 020 7265 4945 E [contact@manaloandwhite.co.uk](mailto:contact@manaloandwhite.co.uk)

PROJECT

Unite: Middlesex St

DRAWING

**D1 - Floor Finish 1F**

SCALE

1:100

STATUS

## Information

PROJECT No.

1107

DRAWING No.

04 4101

REVISION

T 1



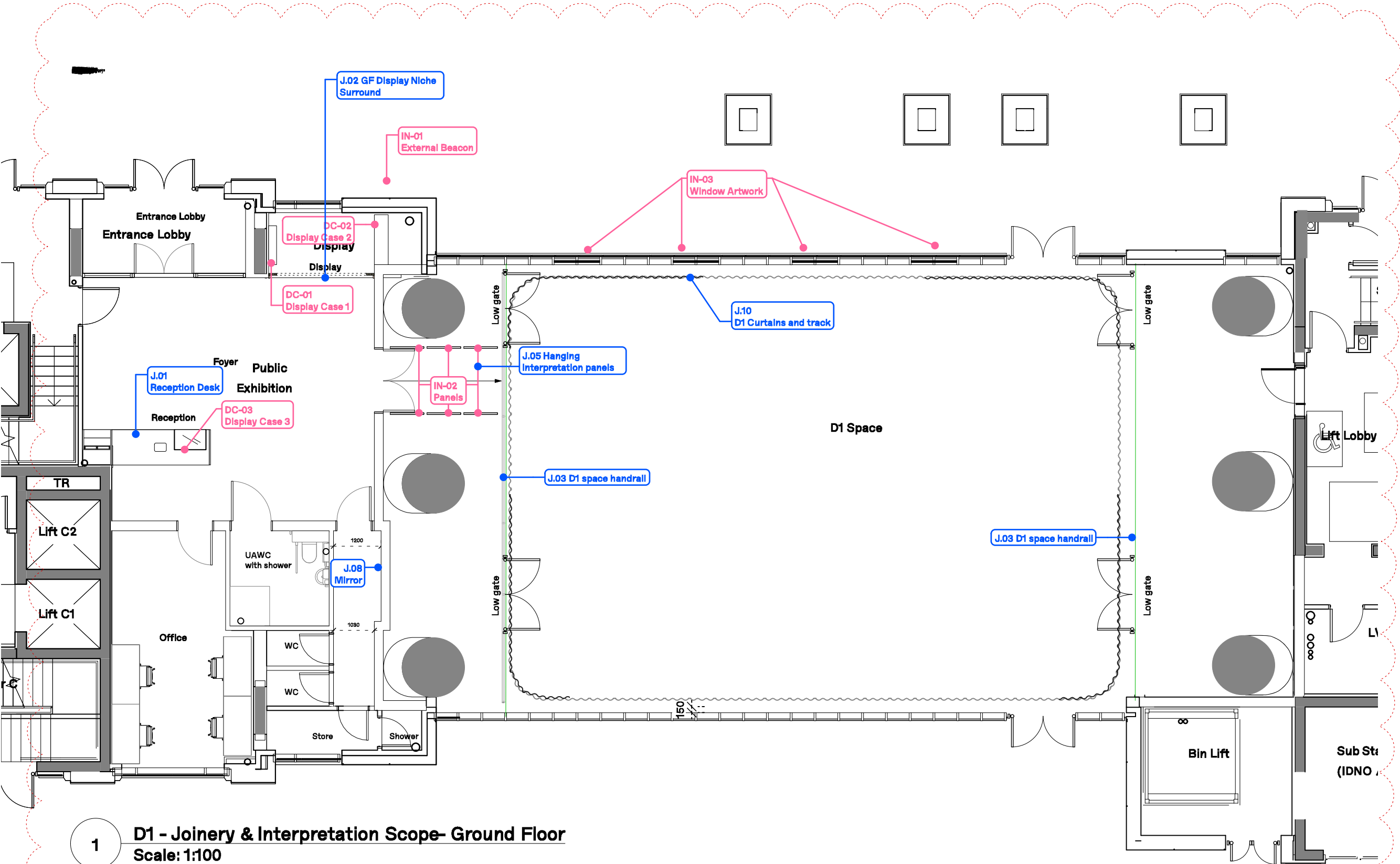

T 1	12/10/2021	Joinery numbers and scope edited
P 2	26/08/2021	ISSUE FOR COSTING
P 1	22/06/2021	Preliminary Issue
REV.	DATE	COMMENT

1100  
1100  
0 1 2 3m

NOTES  
Do not scale from this drawing. All dimensions to be confirmed on site. Architect to be informed of any discrepancies before any action is taken. This drawing is copyright © Manalo & White Ltd and should not be copied or reproduced without Manalo & White Ltd consent.

## Manalo & White

UNIT 301, METROPOLITAN WHARF BUILDING,  
70 WAPPING WALL, LONDON E1W 3SS  
T 020 7265 4945 E contact@manaloandwhite.co.uk

PROJECT  
**Unite: Middlesex St**  
DRAWING  
**D1 - Joinery & Interpretation Scope GF**  
**1:100 @A3**  
STATUS  
**Information**

PROJECT No.	REVISION
<b>1107</b>	<b>T 1</b>
DRAWING No.	
<b>04 3400</b>	

1

**D1 - Joinery & Interpretation Scope- Ground Floor**  
**Scale: 1:100**

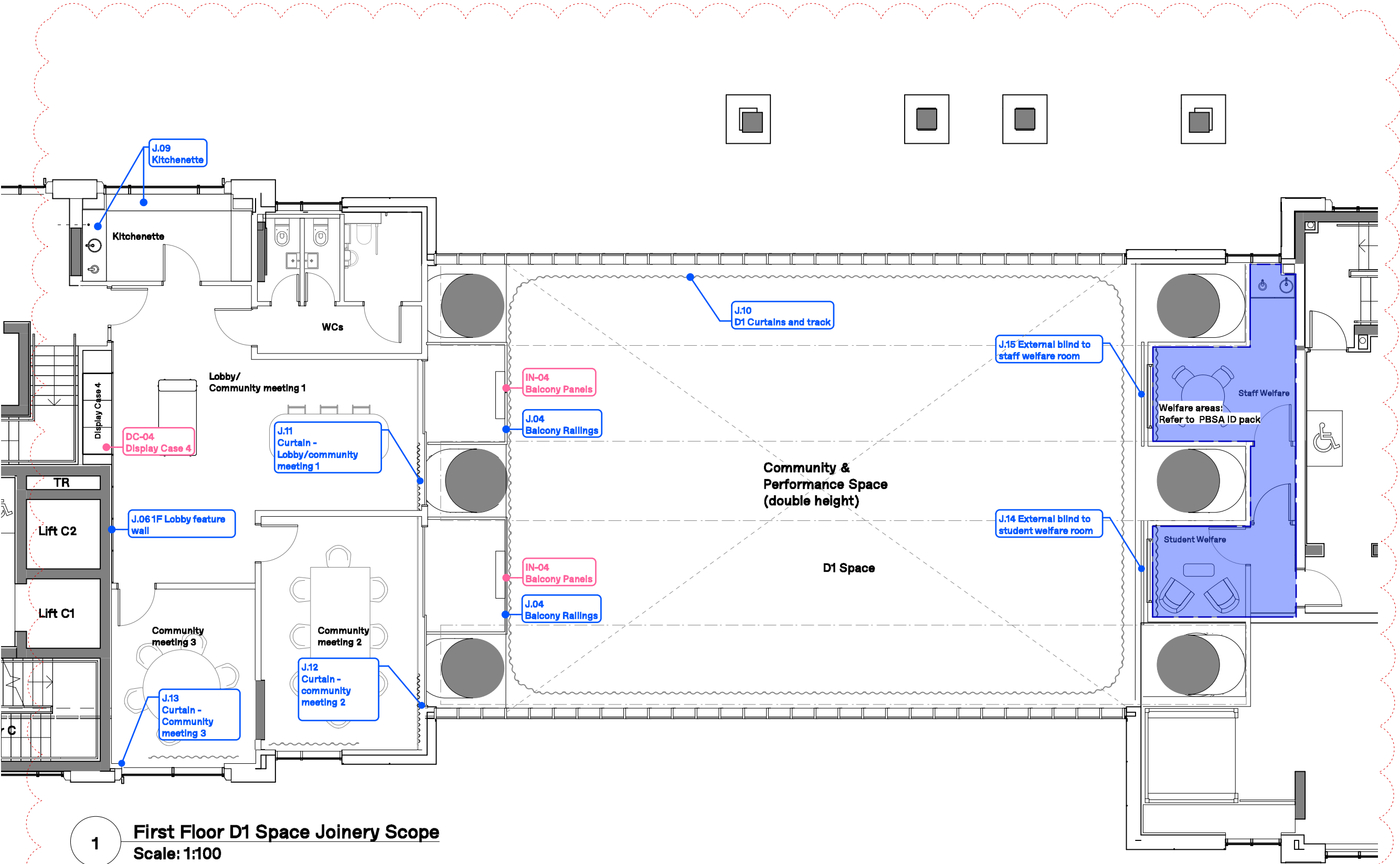

T 1	12/10/2021	Joinery numbers and scope edited
P 2	26/08/2021	ISSUE FOR COSTING
P 1	22/06/2021	Preliminary Issue
REV.	DATE	COMMENT

1100  
1100  
0 1 2 3m

NOTES  
Do not scale from this drawing. All dimensions to be confirmed on site. Architect to be informed of any discrepancies before any action is taken. This drawing is copyright © Manalo & White Ltd and should not be copied or reproduced without Manalo & White Ltd consent.

## Manalo & White

UNIT 301, METROPOLITAN WHARF BUILDING,  
70 WAPPING WALL, LONDON E1W 3SS  
T 020 7265 4945 E contact@manaloandwhite.co.uk

PROJECT  
**Unite: Middlesex St**  
DRAWING  
**D1 - Joinery & Interpretation**  
**Scope 1F**  
**1:100 @A3**  
STATUS  
**Information**

PROJECT No.	REVISION
<b>1107</b>	<b>T 1</b>
DRAWING No.	
<b>04 3401</b>	

1

**First Floor D1 Space Joinery Scope**  
**Scale: 1:100**



Partition Type key	
Description	Sound Insulation (DnT,w + Ctr)
<div><div></div>Standard plasterboard partition</div> <div>PT-01</div>	45dB
<div><div></div>MR Plasterboard partition To receive half height tile finish.</div> <div>PT-02</div>	
<div><div></div>MR Plasterboard partition To receive full height tile finish.</div> <div>PT-03</div>	
<div><div></div>Acoustically lined plasterboard Plasterboard partition &amp; acoustic lining</div> <div>PT-04</div>	56dB
<div><div></div>h2200mm Metal frame with metal mesh infill, verticals fixed back to underside of exposed slab</div> <div>PT-05</div>	

Lining Type key	
<div><div></div>PL-01</div>	Pipe Lining plasterboard to pipework enclosures, to receive paint finish.
<div><div></div>PL-02</div>	Plasterboard Lining Plasterboard to raw concrete, to receive paint finish.

<div><div></div>PT-00</div>	Exposed Concrete Exposed raw concrete
-----------------------------	--

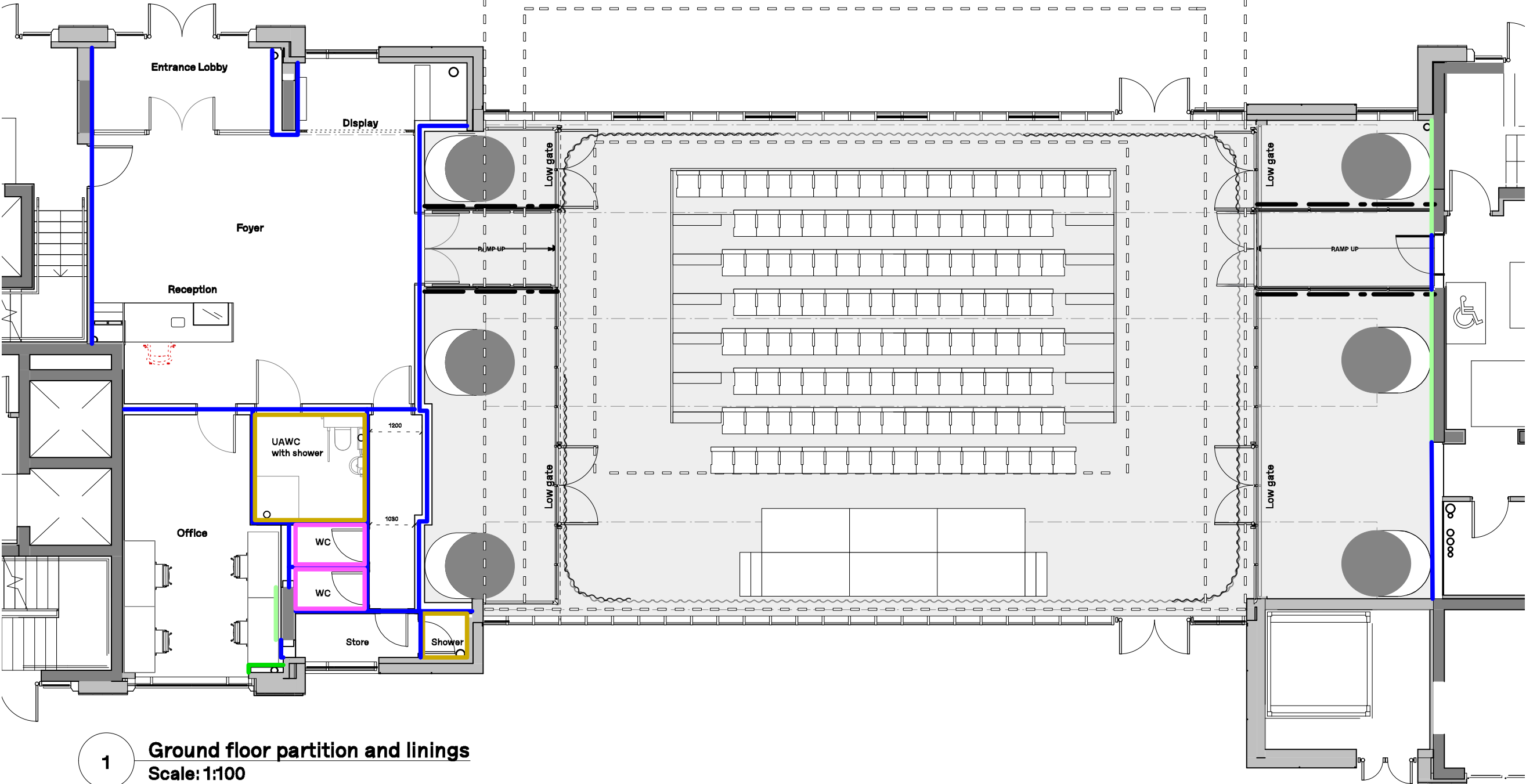

1 Ground floor partition and linings  
Scale: 1:100

Information  
for pricing

T 1	12/10/2021	Stage 4 Issue for costing
REV.	DATE	COMMENT

1:100  
0 1 2 3m

NOTES  
Do not scale from this drawing. All dimensions to be confirmed on site. Architect to be informed of any discrepancies before any action is taken. This drawing is copyright © Manalo & White Ltd and should not be copied or reproduced without Manalo & White Ltd consent.

**Manalo & White**

UNIT 301, METROPOLITAN WHARF BUILDING,  
70 WAPPING WALL, LONDON E1W 3SS  
T 020 7265 4945 Econtact@manaloandwhite.co.uk

PROJECT  
**Unit: Middlesex St**  
DRAWING  
**D1 - GF Partitions and linings**  
SCALE  
**1:100 @A3**  
STATUS  
**Information**

PROJECT No.	REVISION
<b>1107</b>	<b>T 1</b>
DRAWING No.	
<b>04 2201</b>	

Partition Type key	
Description	Sound Insulation (DnT,w + Ctr)
<div><div></div>Standard plasterboard partition</div> <div>PT-01</div>	45dB
<div><div></div>MR Plasterboard partition To receive half height tile finish.</div> <div>PT-02</div>	
<div><div></div>MR Plasterboard partition To receive full height tile finish.</div> <div>PT-03</div>	
<div><div></div>Acoustically lined plasterboard Plasterboard partition &amp; acoustic lining</div> <div>PT-04</div>	56dB
<div><div></div>h2200mm Metal frame with metal mesh infill, verticals fixed back to underside of exposed slab</div> <div>PT-05</div>	

Lining Type key	
<div><div></div>Pipe Lining plasterboard to pipework enclosures, to recieve paint finish.</div> <div>PL-01</div>	
<div><div></div>Plasterboard Lining Plasterboard to raw concrete, to recieve paint finish.</div> <div>PL-02</div>	
<div><div></div>Exposed Concrete Exposed raw concrete</div> <div>PT-00</div>	

Information for pricing

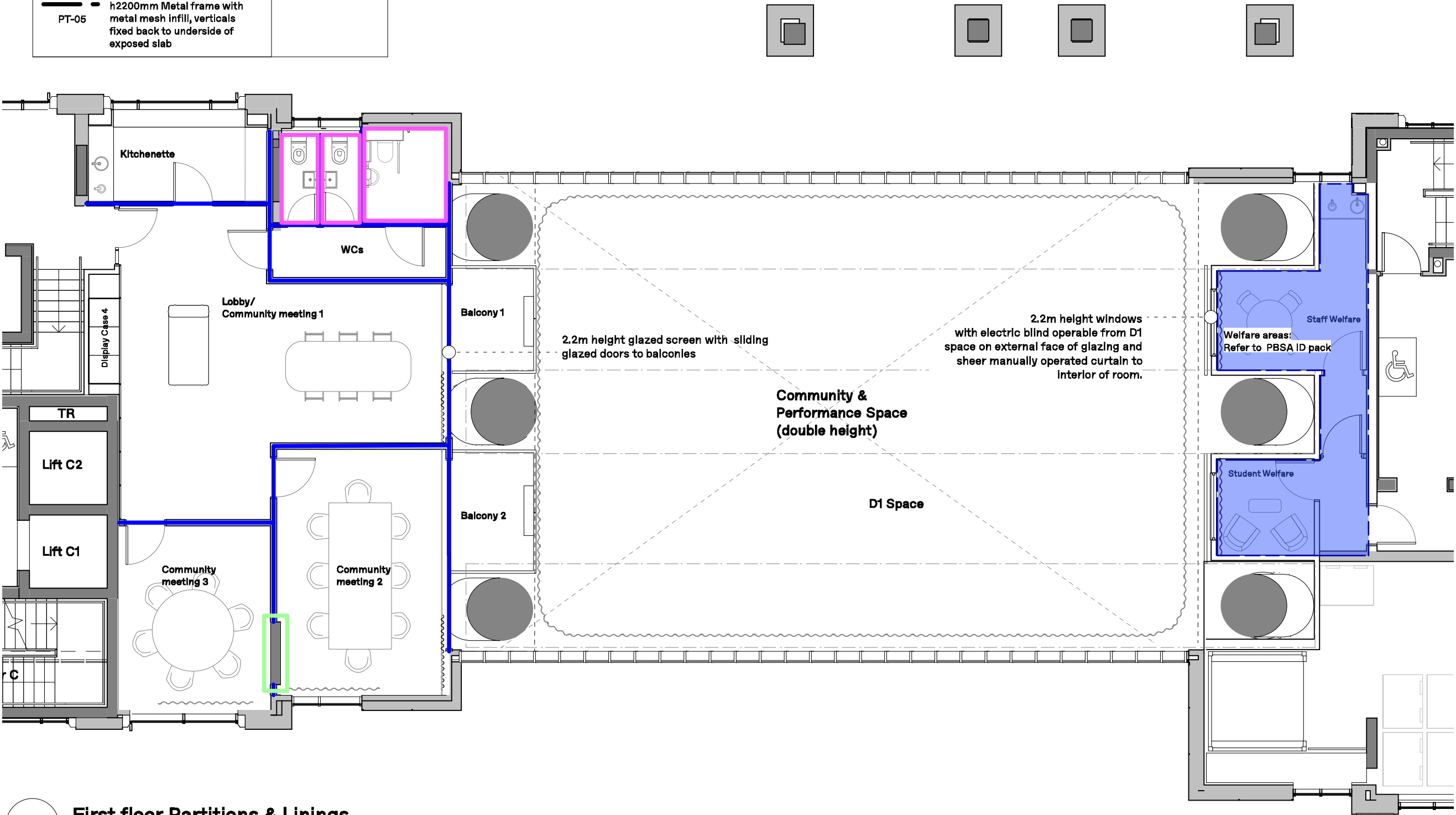

T 1	12/10/2021	Stage 4 Issue for costing
REV.	DATE	COMMENT

1:100  
0 1 2 3m

NOTES  
Do not scale from this drawing. All dimensions to be confirmed on site. Architect to be informed of any discrepancies before any action is taken. This drawing is copyright © Manalo & White Ltd and should not be copied or reproduced without Manalo & White Ltd consent.

**Manalo & White**

UNIT 301, METROPOLITAN WHARF BUILDING,  
70 WAPPING WALL, LONDON E1W 3SS  
T 020 7265 4945 Econtact@manaloandwhite.co.uk

PROJECT  
**Unite: Middlesex St**  
DRAWING  
**D1 - 1F Partitions and linings**  
SCALE  
**1:100 @A3**  
STATUS  
**Information**

PROJECT No.	REVISION
<b>1107</b>	<b>T 1</b>
DRAWING No.	
<b>04 2202</b>	